

**Sw**

**For non-commercial use only**

RAMM

only.

---



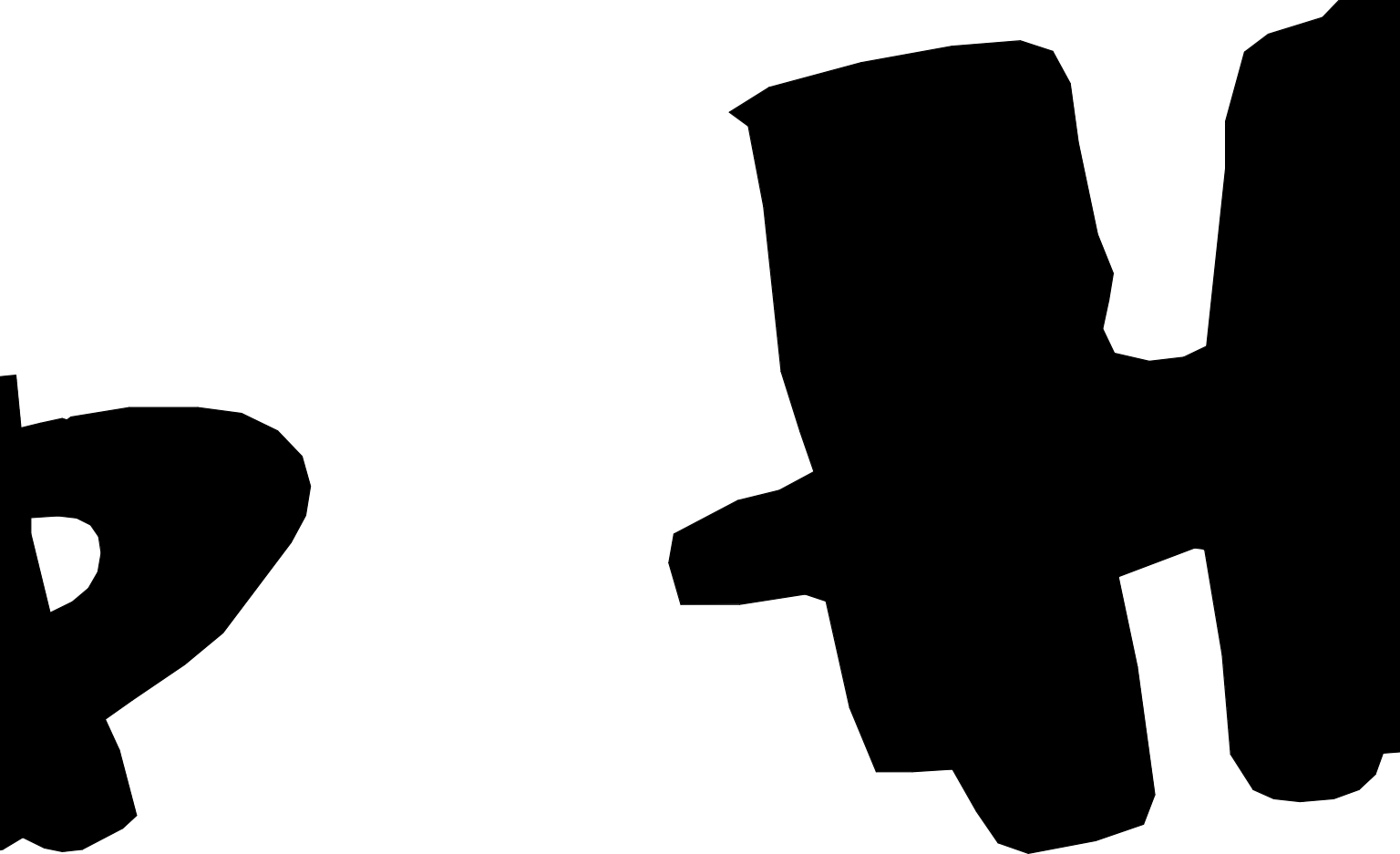

Law

	<b>X2</b>	
--	-----------	--

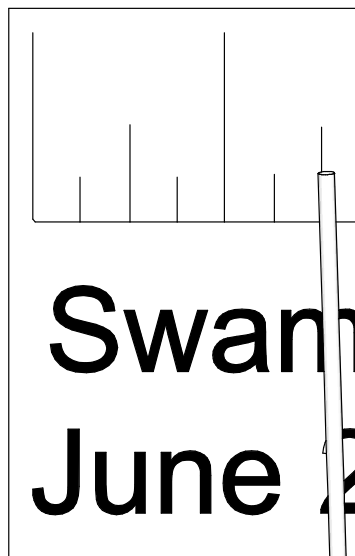

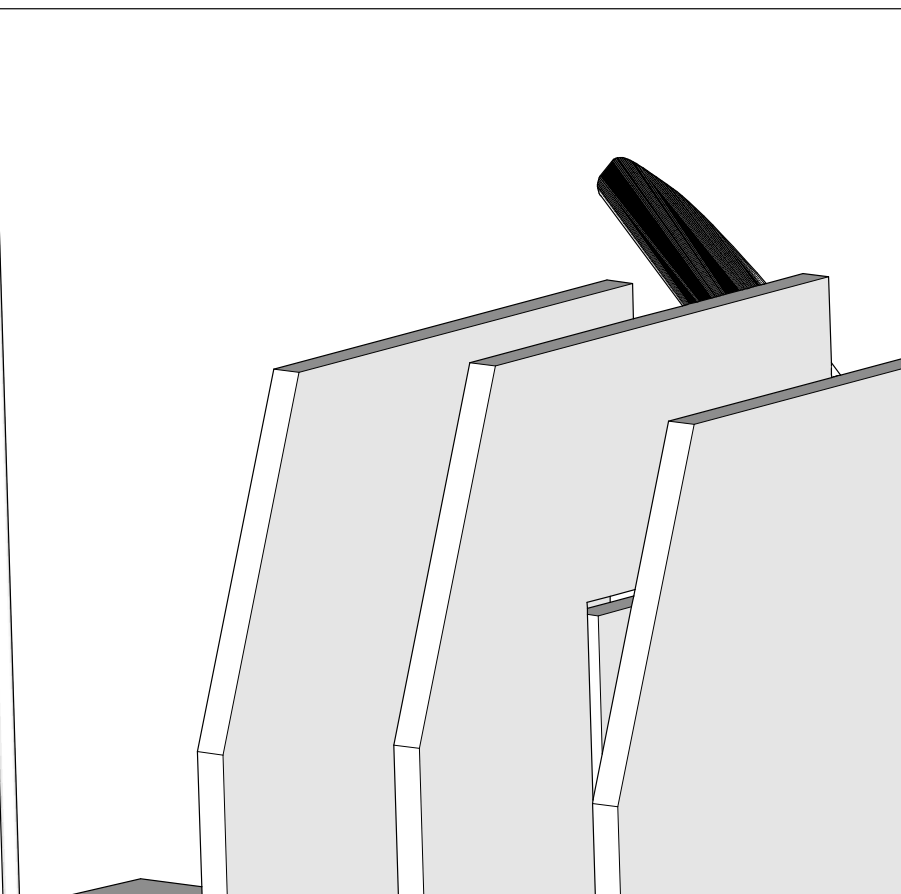
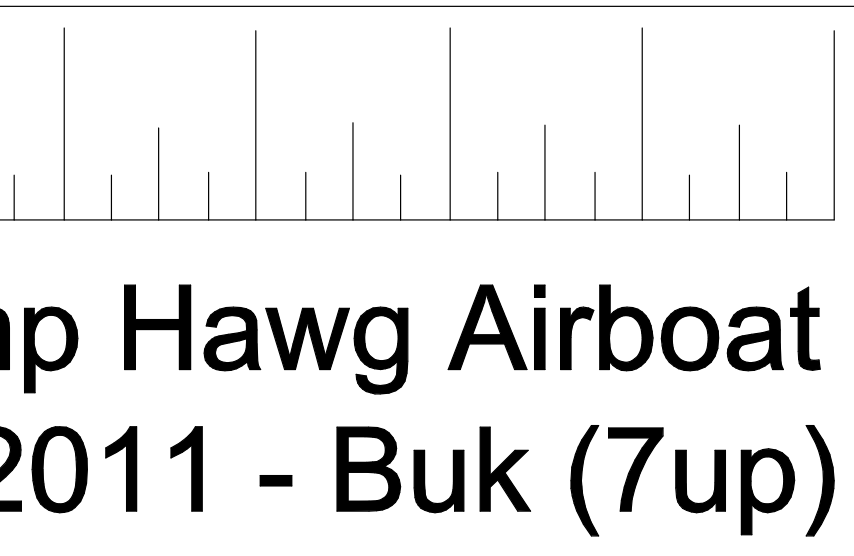

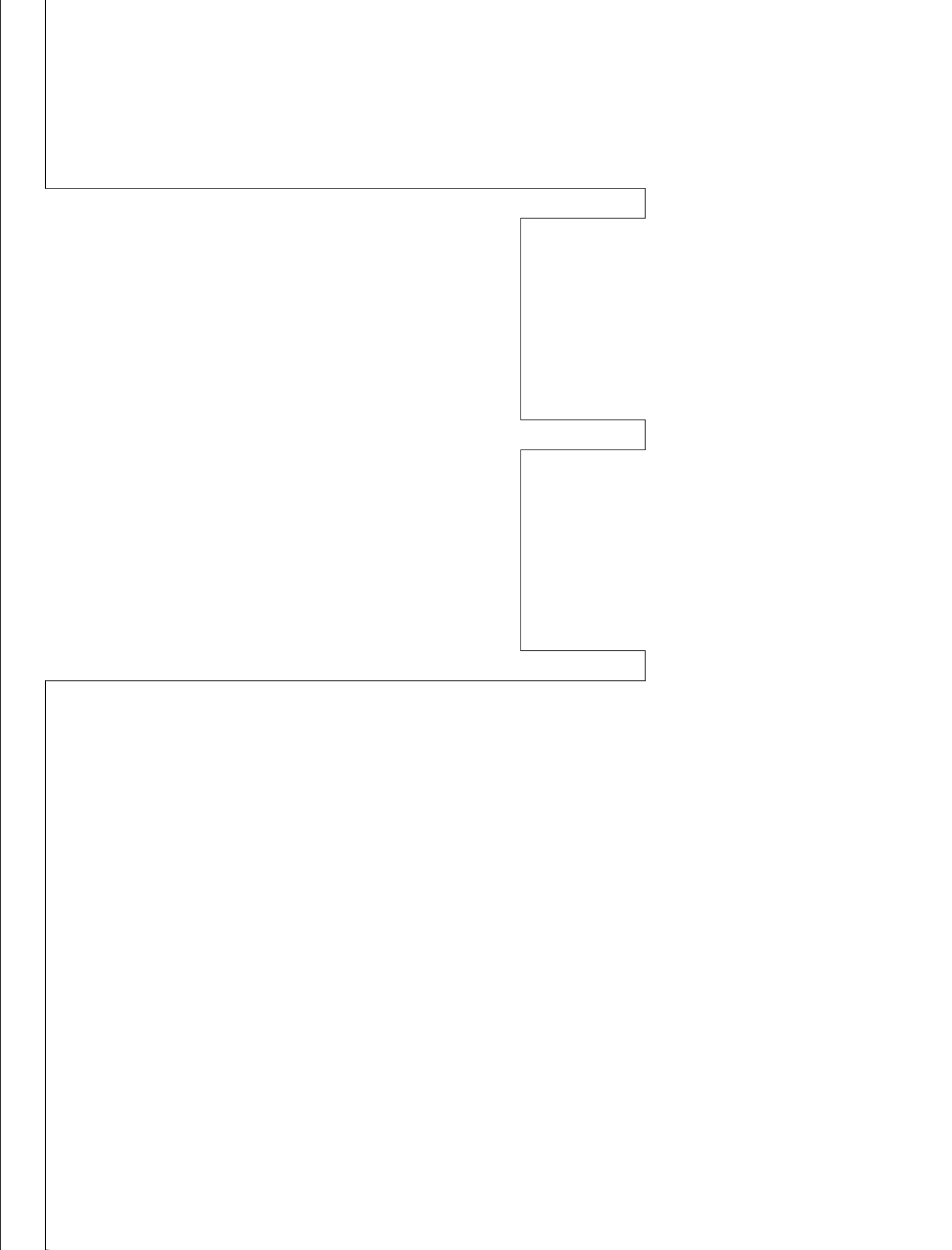

# **Battery compartment**

**RX/Servo  
compartment**





# 1/8" ply motor mount

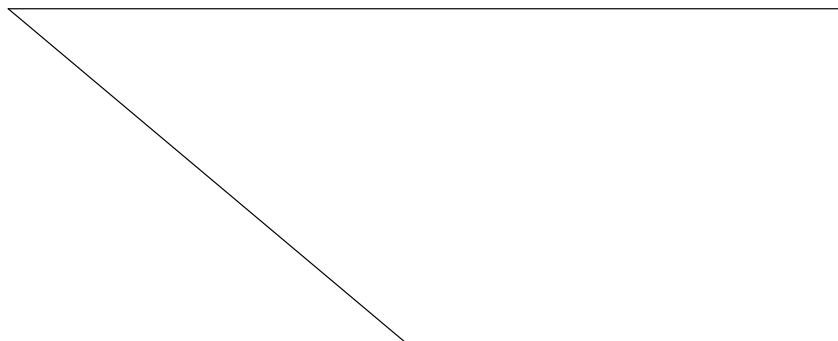
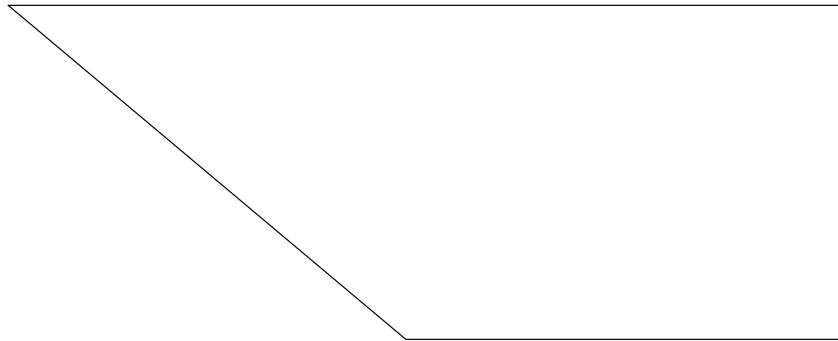
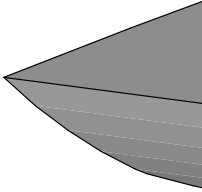
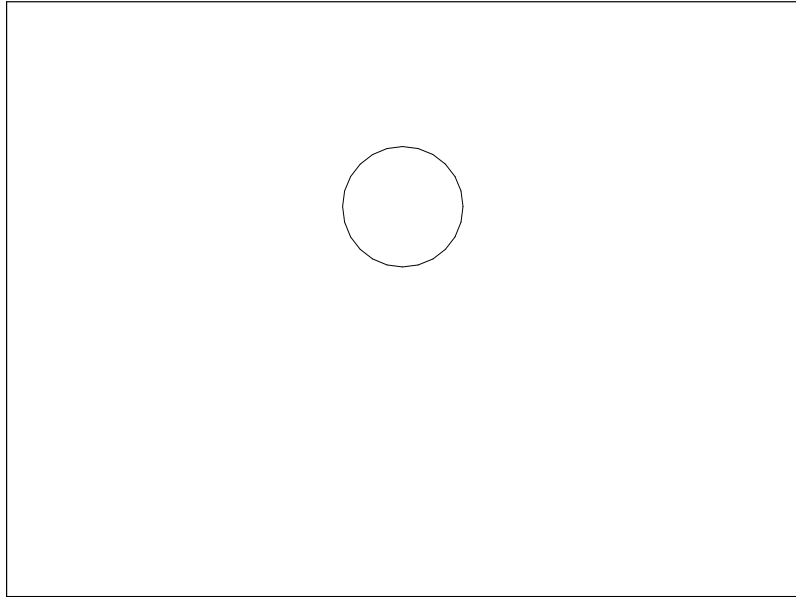

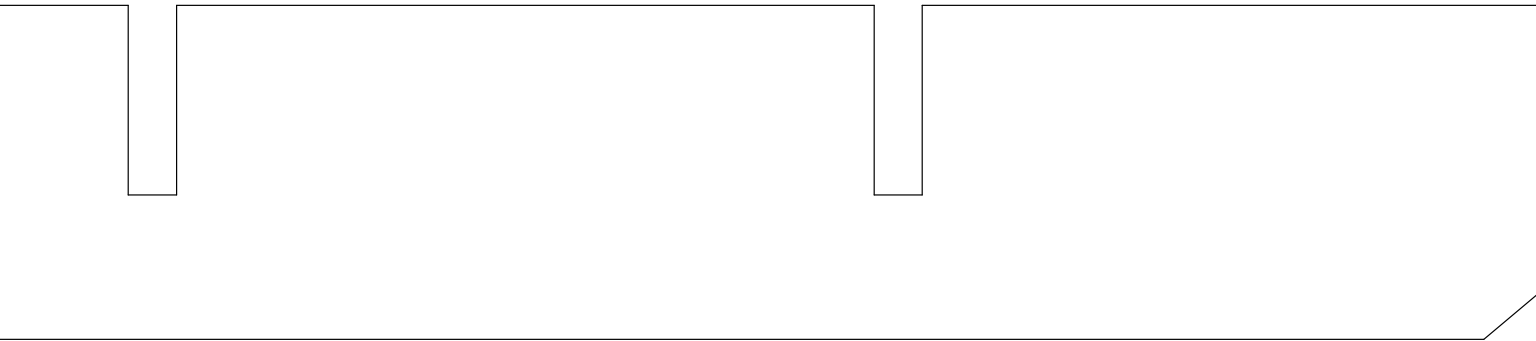
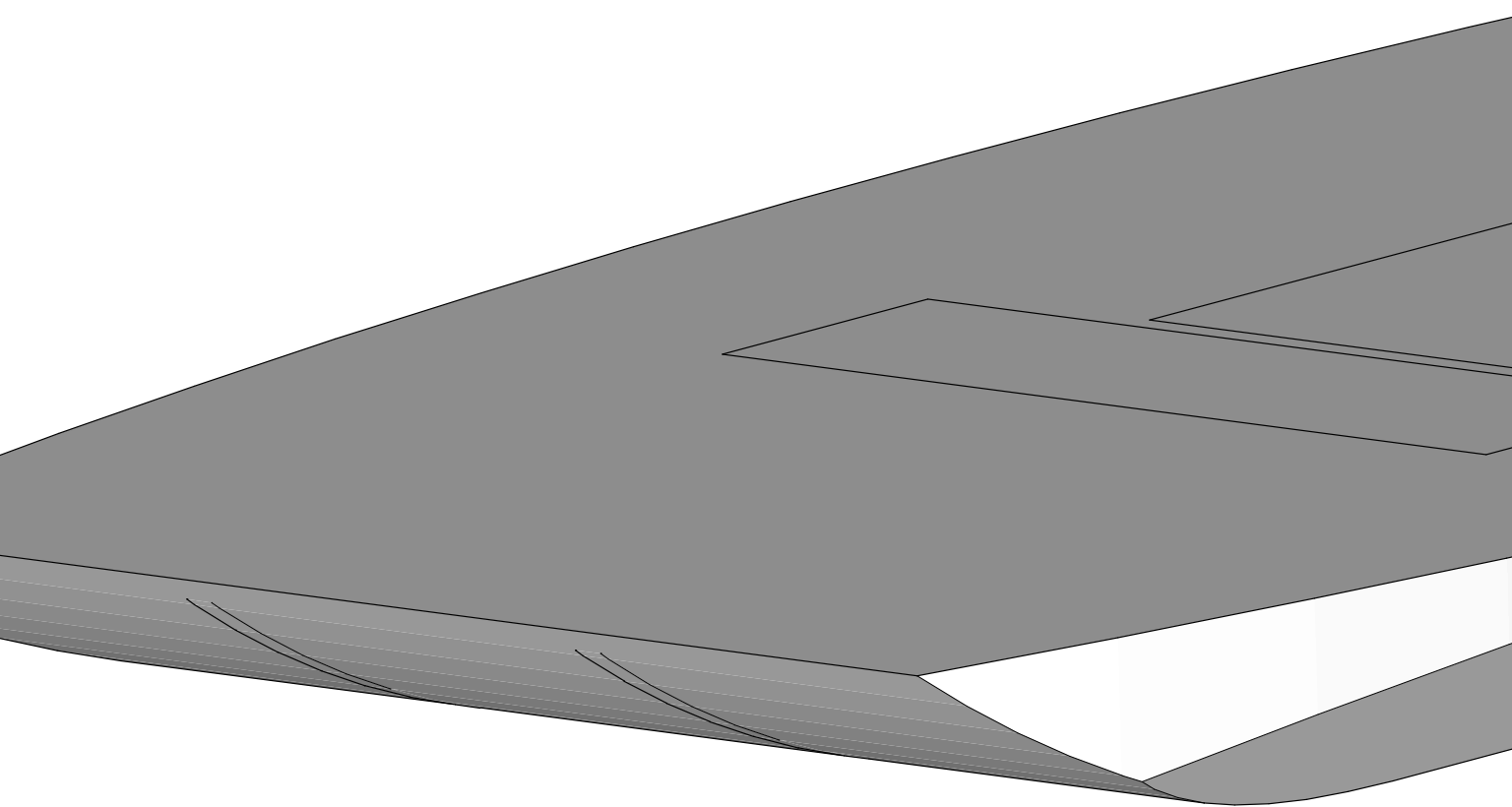

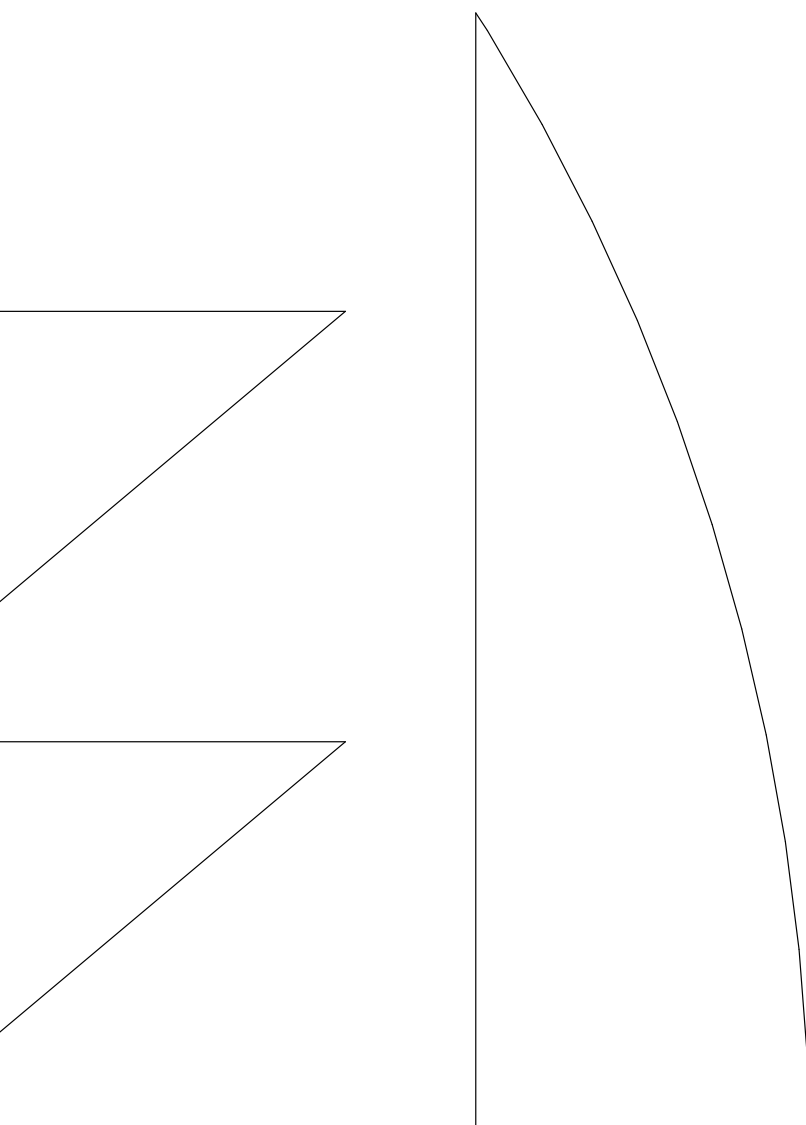
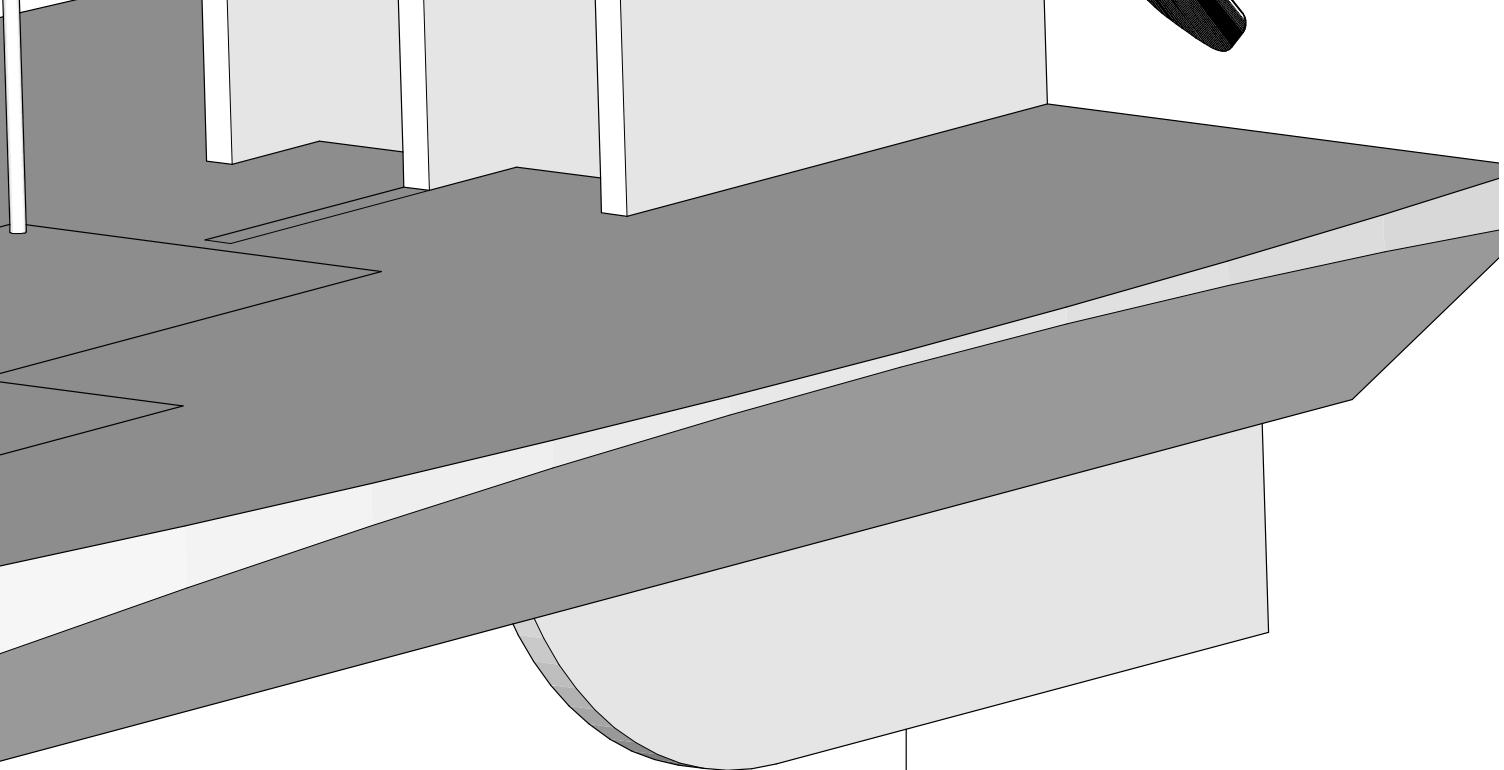

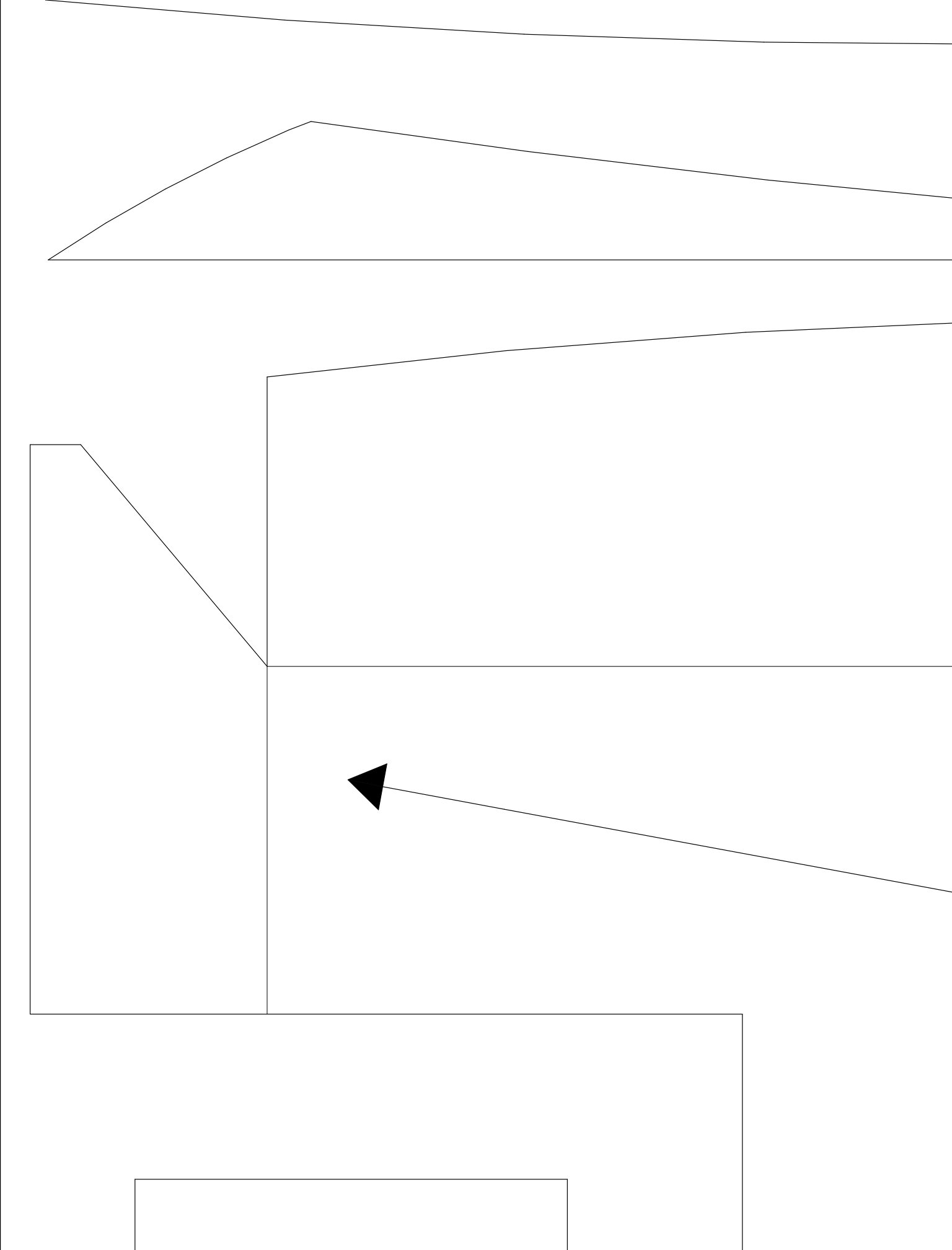

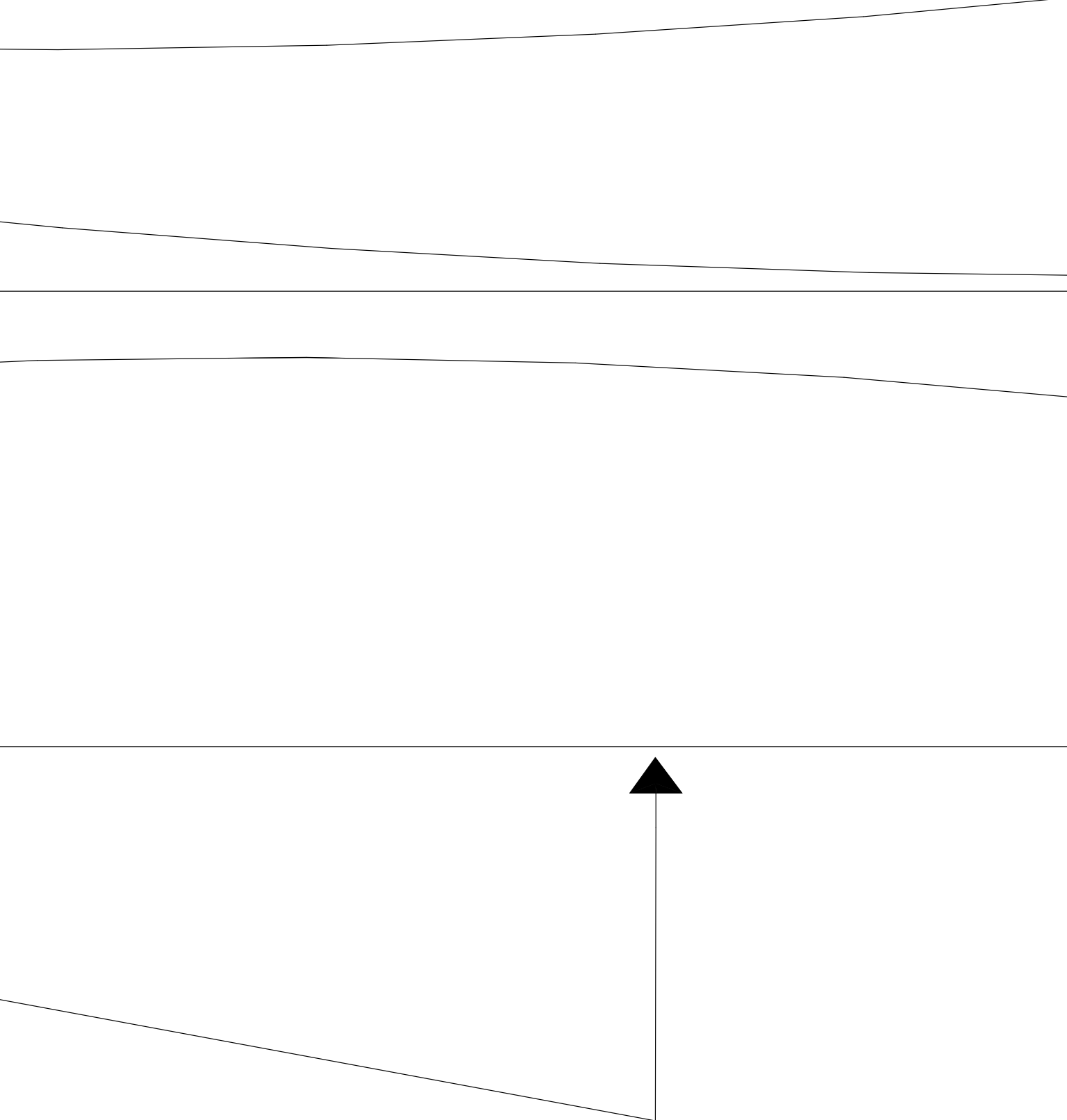

**Fold lines**  
**Cut 50% of foam thickness**

# X2



ness

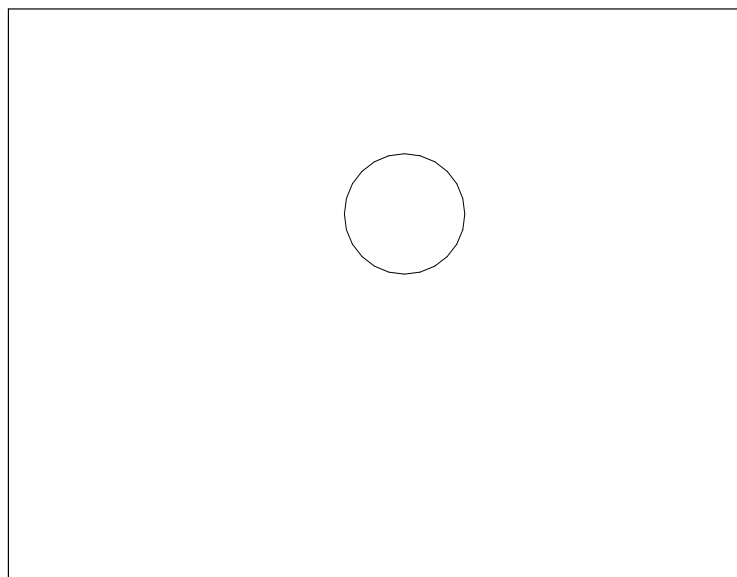
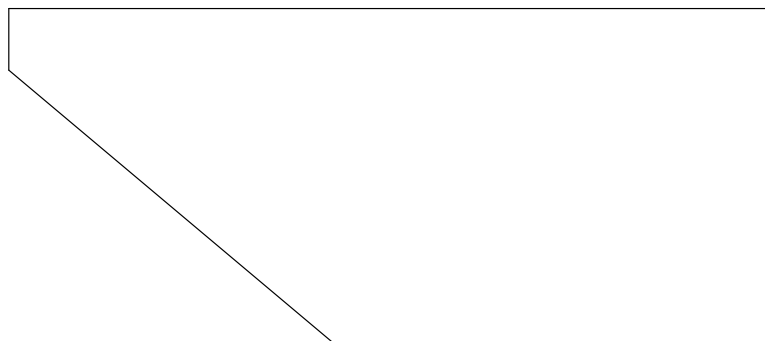
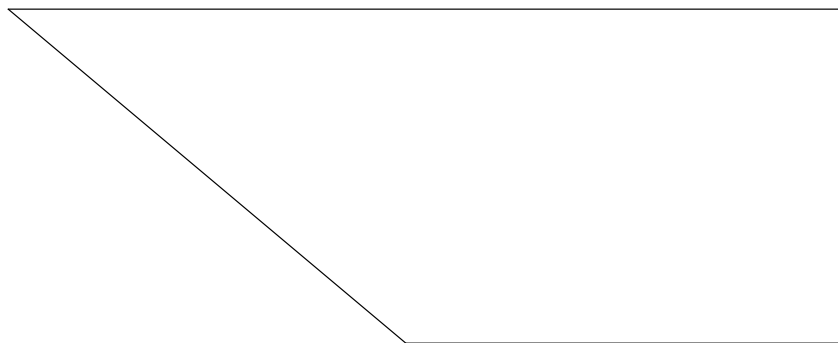
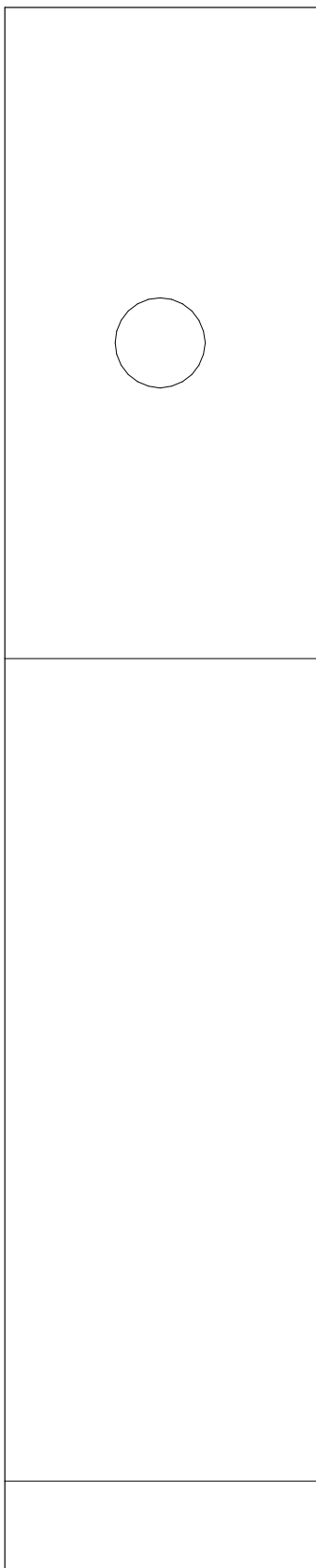



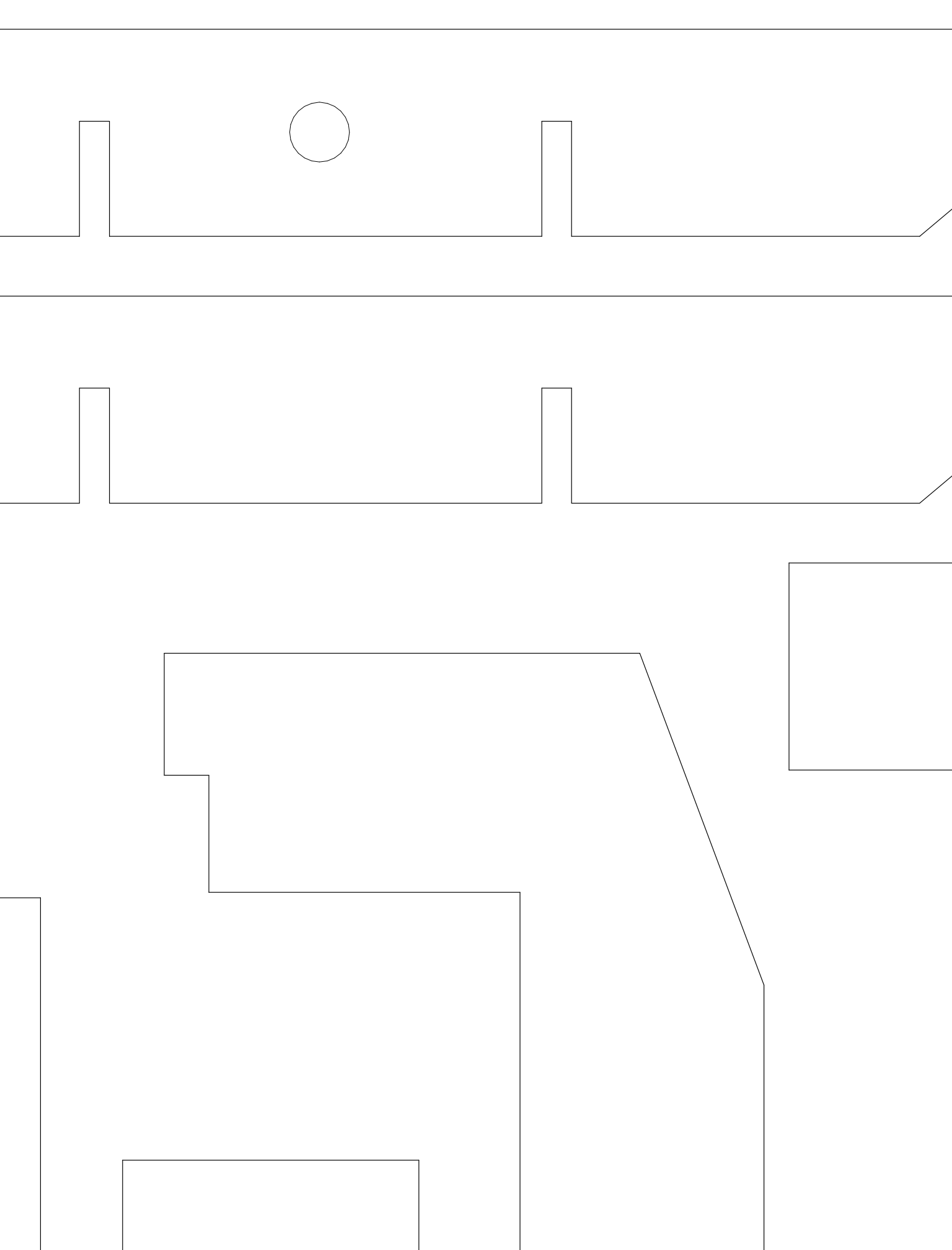

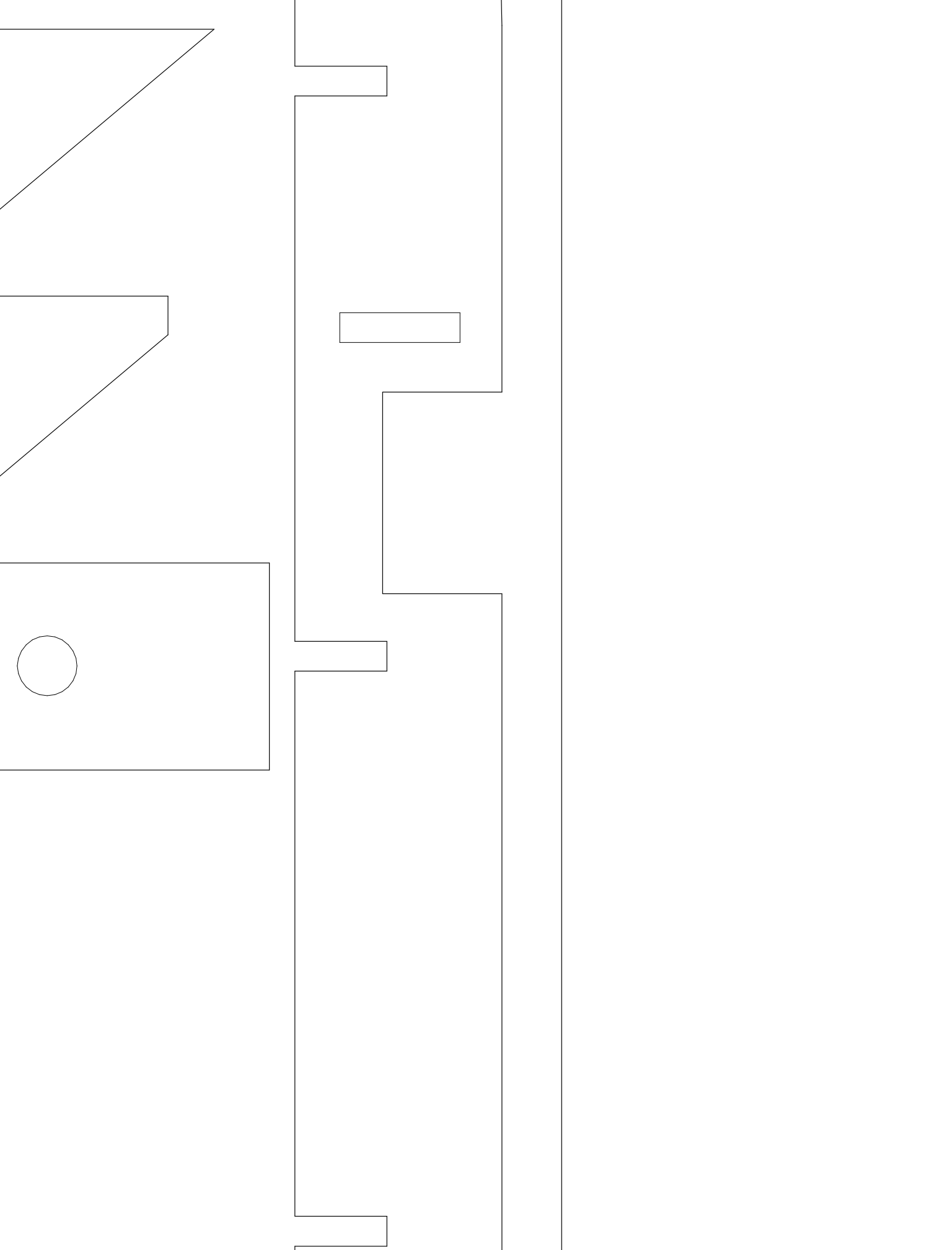

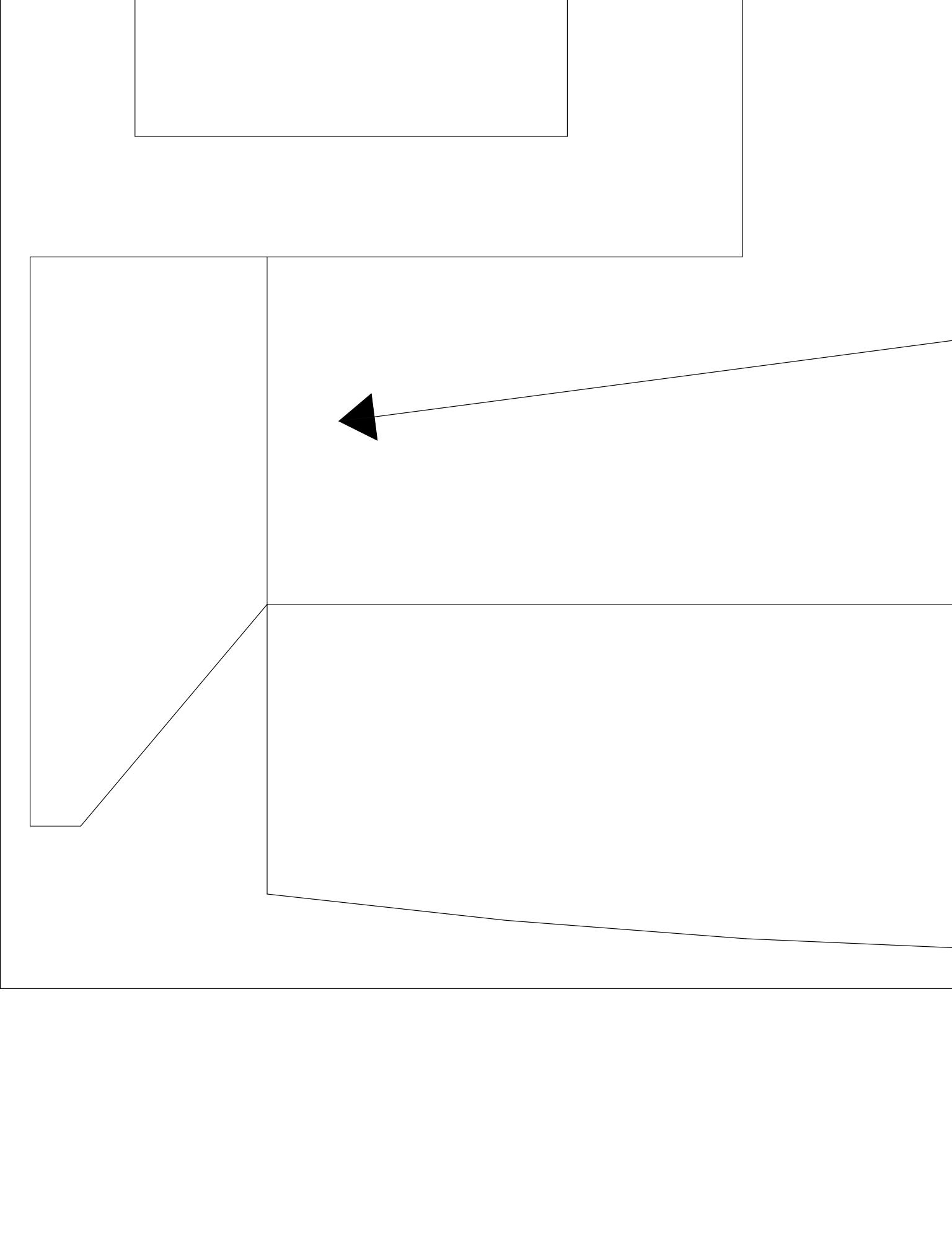

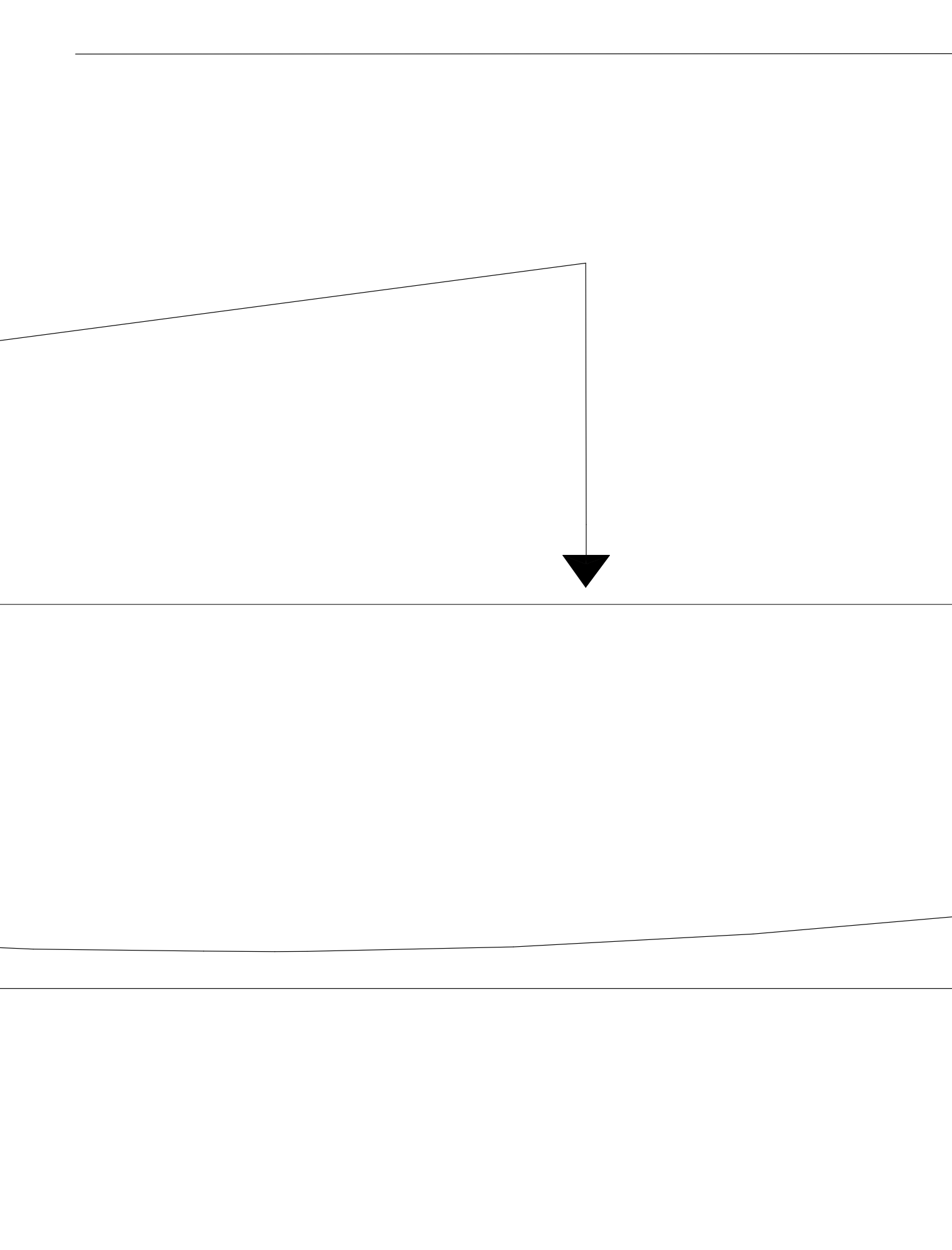

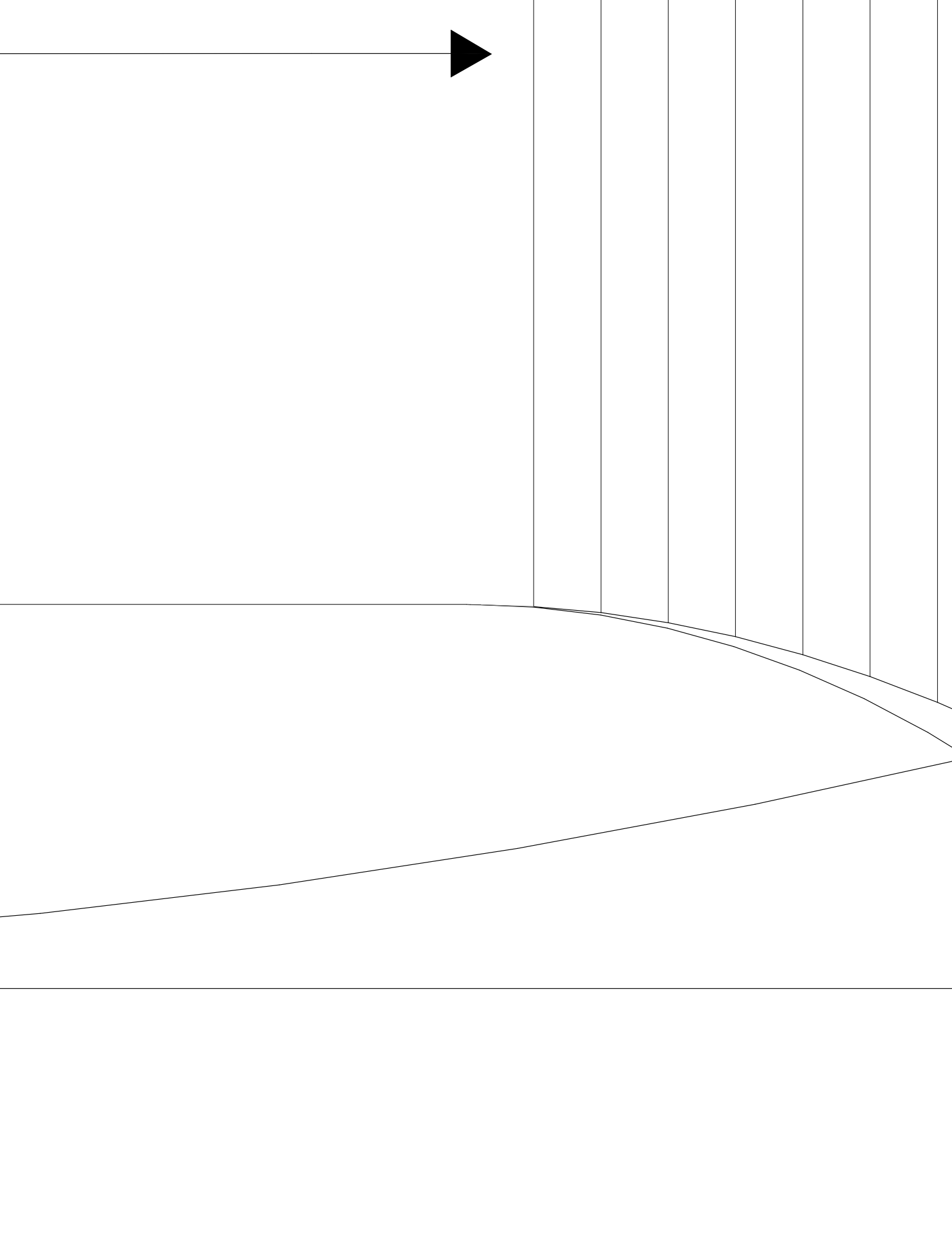

**Rud**

The background features a series of black geometric lines and shapes. On the left, there are several vertical and horizontal lines forming a stepped pattern. On the right, a large, irregular shape is defined by a series of connected line segments, including a long diagonal line sloping upwards from left to right. The overall composition is minimalist and architectural.

**der**

